

User manual

Product Features

The product is a touch panel which conforms to IEEE 802.15.4 basic agreement and is suitable for smart home system built by ZigBee network. It can realize real-time control, local interregional control, logic control of local preset settings and local mobile control through the ZigBee gateway. If the gateway is connected to the Internet, it can realize remote control.

Main Parameters

Working Voltage	~100V~240V 50Hz/60Hz μ
Rated Current	Light/Curtain/Dimmer/Fresh Air Panel: 1A/gang When the load current of light panel is 16A, the rated current is 1.5A/gang.
Rated Power	Light linkage panel/scene panel: 1W 1-gang light panel/ 1-gang curtain panel: 1.5W 2-gang light panel/ 2-gang curtain panel: 2W 3-gang light panel: 2.5W 4-gang light panel: 3W
Working Temperature	-10℃~+50℃
Working Humidity	35%~85%RH
Standby Power	0.5W
Communication Interface	ZigBee wireless communication
Product Size	86*86*36mm
Installation	86 built-in box (minumum depth: 48mm)

Package Contents

- Panel: 1
- Screw: 2
- User manual: 1

Features

Panel	Features
Scene/Curtain/ Light/Dimmer/ Light Linkage/ Fresh Air Panel	1.Use ZigBee network protocol for flexible networking; 2.AC power supply for stable system; 3.Support audio prompt(optional) and indicator light prompt, customized startup and shutdown; 4.Control by capacitive touch button; 5.Use 86 type mounting box for installation;
Light/Curtain/ Fresh Air Panel	1.Work with ZigBee network coordinator(gateway) and realize remote control via mobile phone, pad or PC; 2.Work with scene panel to realize multiple controls or scene control, storing up to 16 scenes; 3. Built-in relay driver
Scene Panel	1.Realize centralized control on multiple devices; 2.Synchronization of scene status indication; 3.Flexible scene configuration through APP software or offline configuration.
Light/Curtain Linkage Panel	1.With linkage control function, it can bind the light or curtain panel. 2. It allows synchronous display of light or curtain status.
Dimmer/Dimmer Linkage Panel	1.Stepless dimming is adopted to improve user experience and meet various requirements on operation and brightness. 2.Each circuit has protection of short circuit and overload. 3.The dimmer linkage panel can bind the dimmer panel to realize wireless double control.

Appearance (The following images are only part of the panel sketches, and the real object shall prevail.)

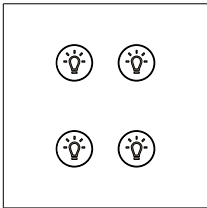

Light/light linkage panel



Scene panel

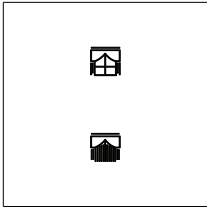

Curtain panel

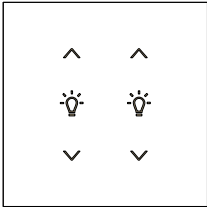

Dimmer/dimmer linkage panel

Note: use the Up and Down buttons for dimming; use the middle button to turn on/off the light.

Installation

(1)Wiring

Note:Please make sure the power is off during wiring.

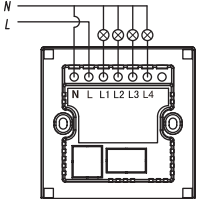

1-gang/2-gang/3-gang/4-gang light panel

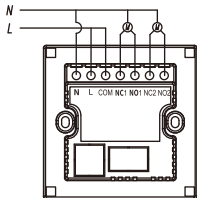

1-gang/2-gang curtain panel

Connect control line of 1-gang light panel with terminal L1;
Connect control line of 2-gang light panel with terminal L1,L2;
Connect control line of 3-gang light panel with terminal L1,L2,L3;
Connect control line of 4-gang light panel with terminal L1,L2,L3,L4;
Connect live wire (L) with terminal L;
Connect neutral wire(N) with terminal N;

Connect control line of 1-gang curtain panel with terminal NC1(open),
NO1(close);
Connect control line of 2-gang curtain panel with terminal NC1/NC2
(open),NO1/NO2(close);
Connect live wire (L) with terminal L;
Connect neutral wire(N) with terminal N;

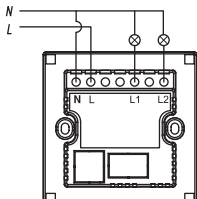

1-gang/2-gang dimmer panel

Connect control line of 1-gang dimmer panel with terminal L1;
Connect control line of 2-gang dimmer panel with terminal L1,L2;
Connect live wire (L) with terminal L;
Connect neutral wire(N) with terminal N;

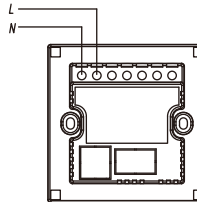

Linkage panel of light/dimmer/curtain/ and scene panel

Connect live wire (L) with terminal L;
Connect neutral wire (N) with terminal N;

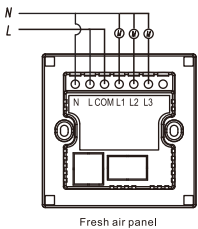

Connect control line of 1-gang fresh air panel with terminal L1;
Connect control line of 3-gang light panel with terminal L1,L2,L3;
Connect live wire (L) with terminal L;
Connect neutral wire(N) with terminal N;

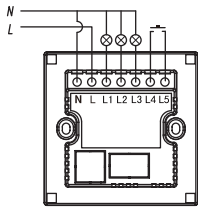

Connect control line of 1-gang light panel with terminal L1;
Connect control line of 2-gang light panel with terminal L1,L2;
Connect control line of 3-gang light panel with terminal L1,L2,L3;
Connect control line of 1-gang light linkage panel with terminal L4,L5;
Connect live wire (L) with terminal L;
Connect neutral wire(N) with terminal N;

1-gang/2-gang/3-gang light panel+1-gang external linkage

Note: The external linkage switch is a normally opened self-reset switch.

(2) Panel Installation Diagram

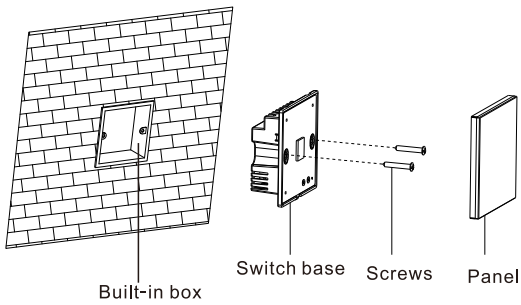

- Assemble the switch base into built-in box and connect the wires.
- Fix the switch base on built-in box with screws.
- Buckle the panel on switch base and power it on.

Note:

- 1.Please be sure to turn the power off during installation.
- 2.Please wrap the wires during connection in case of short circuit.
- 3.The above is only the installation diagram, and the specific panel appearance and base shall be subject to the actual product.

(3) Disassembly

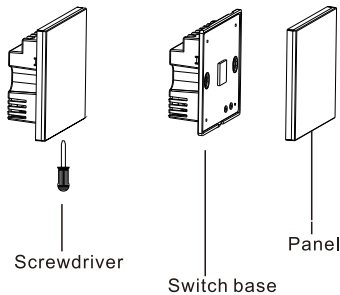

- Please make sure to turn off the power.
- Insert the screwdriver into the hole underneath the base to take down the touch panel.
- The above is only the sketch of panel disassembly, and the specific panel appearance and base shall be subject to the actual product.

Operation

(1) Button Settings

- When the panel is powered on, all the controllable indicator lights will flash once. If the device has joined ZigBee network, the indicator lights will flash five times, indicating the initialization is completed and the device enters normal standby mode.
- Normal standby mode
In normal standby mode, short press on the button for 0.2~1S to control ON/OFF, Long press on the first button for 3~6S. When the indicator lights flash, press the button again for 3-6S (if there is no operation within 10S, the device will return to standby mode). If the indicator lights flash slowly, it indicates that the device is joining ZigBee network (the panel can be added into the APP).
Note: If pressing the button over 6S, the indicator light won't flash.
- Join ZigBee network
Please join ZigBee network after resetting the device.
When joining ZigBee network, if there is no operation for more than 60S or after receiving the message of network joining, the device will return to standby mode automatically; If the device joined ZigBee network successfully, it will emit a beep and then return to standby mode.

(2) Pairing

- Download and install "hiHome" APP on smartphone. The gateway must be added after login. Scan QR code on rear cover of gateway to add it on the APP. After adding the gateway, relevant settings of panel can be made.
Note: When pairing, the smartphone and gateway should be on the same LAN.

(4) Adding equipment (take curtain panel as an example)

- After login to the mobile APP, you can add any panel on the home page as shown in Figure (1) and click  on the upper right corner to add devices (please ensure that the smartphone and gateway are on the same LAN).
- Select "Curtain" and press the first button on the curtain panel for 3 to 6 seconds. The panel button will flash quickly. Then press the panel button again. Click "Start to add" on the mobile phone APP. When the panel emits a beep, the APP will show the following figure (2). After completing the information, click "Save" to finish adding.
- After adding, the curtain panel can be switched on or off via mobile APP.



Figure (1)

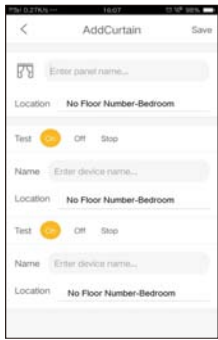

Figure (2)

⚠ Attention

- Please make sure to cut off the power during installation or maintenance.
- The load power of panel should be within the scope of permission.
- Please follow this manual for wiring and installation.
- Photos are for reference only, please take the real product as the standard.

